



Finish

Gloss Enhancer



Product Description

G3 Finish Gloss Enhancer is a final finishing product with excellent filling capabilities for minor scratches and swirls. Leaving extra shine and a protective layer on the surface, it offers a water repellent yet breathable and durable coating on all paint systems.

G3 Finish is ideally applied using a Farécla G Mop 6" Red Waffle Pad (**PFR601**), which was engineered in tandem with the liquid to provide a marked performance improvement versus other pads. Our label stripe is colour coded to match the transfer on the correct pad for ease of identification.

Product Information

Size	Code	Ctn Qty
450ml	G3F401	12
900ml	G3F901	6

Key Benefits

• Excellent Filling Capabilities	Helps remove minor swirls and holograms from all paint systems to ensure a flawless finish
• Rapidly Enhanced Gloss	Provides added shine quickly with no need to re-apply, saving time and money
• Protective Properties	Provides a durable, water-repellent barrier that allows paint to breathe (if not fully cured)
• Colour Restoration	Restores the lustre to faded paintwork for ultimate customer satisfaction
• Engineered in Tandem with Red Waffle Pad	Marked performance improvements versus other pads. Waffle structure keeps surface cool and makes navigating difficult body contours easier



Use With

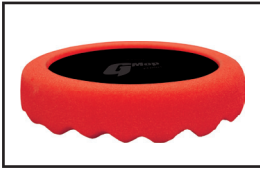

G Mop 6" Red
Waffle Pad
PFR601



G Mop 6" Back Plate
with White Interface Pad
BPI601 (14mm)
BPI606 (16mm)
BPI612 (5/8")

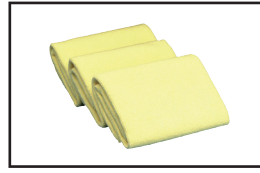

Farécla Finishing
Cloth
FC-3

How To Use

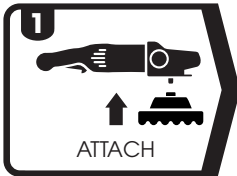

1
Attach waffle
pad to polishing
machine
PFR601

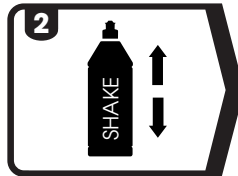

2
Shake bottle well
before use
G3F401 (450ml)
G3F901 (900ml)

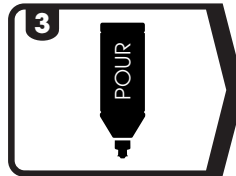

3
Fill one dimple of
waffle pad with
product

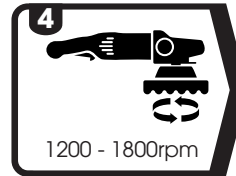

4
Compound at
speed of 1200 -
1800rpm



5
Wipe clean with
Finishing Cloth
FC-3 (cloth)

Technical Information

Appearance: **Grey coloured liquid**
Viscosity: **High viscosity**
VOC Content: **29.9% of total product**
Relative Density: **1.05**
pH: **7.5**
Paint Type Compliance: **MS, HS & UHS (SRCs)**